

SH W1011H

Wall-Mounted Gas Spring

Fits most 17"-32" flat & curved Monitors

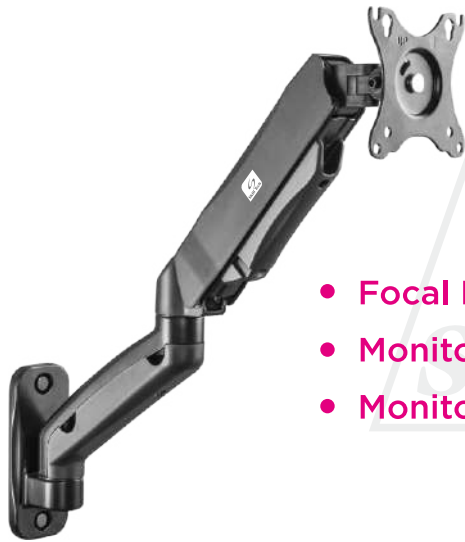

- Focal Distance
- Monitor Angle
- Monitor Height

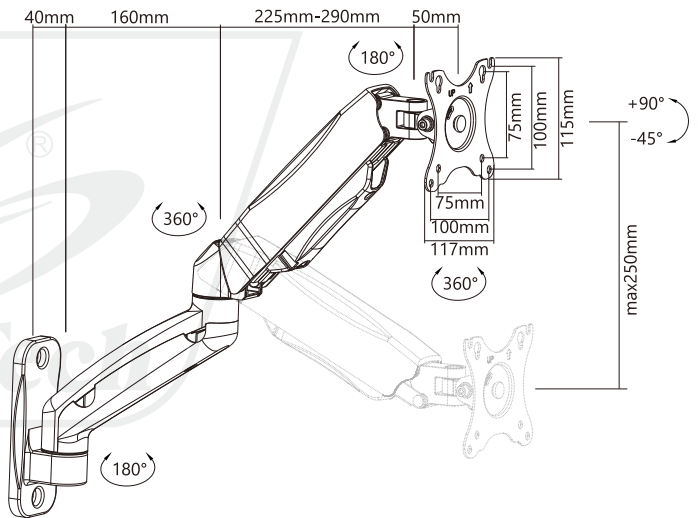

Weight Capacity
6.5kg/14.3lbs

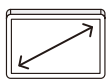

Screen Size
17"-32"



Tilt Range
+90°--45°

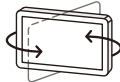

Swivel Range
+90°--90°

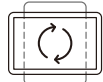

Screen Rotation
+180°--180°

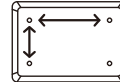

VESA Compatible
75x75 100x100



Curved Monitor

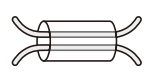

Cable Management

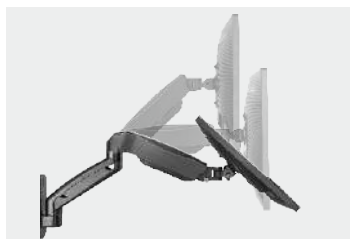

Gas Spring Hovering System
adjusts your monitor with the touch of your finger.

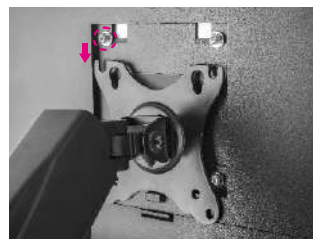

Effortless Assembly
slip your monitor in or slip it out with ease.



Rock Solid Support
keeps a firm grip on your monitor.



Integrated Cable Management
keeps your cables neat and the arm free of intanglement.